

ML12-26_(12V26AH)

Features

Maintenance-free operation
Compact design

Stable quality and high reliability
10 years design time (at 25°C)



Application

- Telecommunication system
- Alarm and security system
- Backup power for testing and measuring instruments
- UPS
- Emergency lighting
- Fire alarm and security systems
- Auto control system
- Electronic apparatus and equipment
- Communication power supply
- DC power supply

Specifications

Nominal Voltage	12V (6 cells)	Operating Temp.Range	Discharge: -15 - 50°C (5 - 122°F)
Nominal Capacity	26AH (20hr, 1.80V/cell, 25 °C/77°F)		Charge : 0 - 40°C (32 - 104°F)
	24.4AH (10hr, 1.80V/cell, 25 °C/78°F)	Storage : -15 - 40°C (5 - 104°F)	
	22.1AH (5hr, 1.75V/cell, 25 °C/77°F)	Nominal Operating Temp.Range	25 ± 3°C (77 ± 5°F)
Dimension	15.6AH (1hr, 1.60V/cell, 25 °C/77°F)	Cycle Use	14.2~14.4V (25°C/77°F) Temp.Coefficient -30mV/°C
	Length 175± 2mm		Initial Charging Current Less than 7.8A
	Width 166.5± 2mm	Standby Use	13.5~13.8V (25°C/77°F) Temp.Coefficient -20mV/°C
	Container Height 125 ±2mm		No limit on Initial Charging Current
Approx Weight	Total Height(with Terminal) 125 ± 2mm	Capacity affected by Temperature	40°C (104°F) 103%
Terminal	Approx 7.9Kg		25°C (77°F) 100%
Container Material	T1 / F3		0°C (32°F) 86%
Max. Discharge Current	ABS	Self Discharge	Sunstone ML series batteries may be stored for up to 6 months at 25°C (77°F) and then a freshening charge is required.
Internal Resistance	330A (5S)		For higher temperatures the time interval will be shorter.
	Approx 10.5mΩ		

Constant Current Discharge (Amperes at 25°C/77°F)

F.V/Time	5min	10min	15min	30min	45min	1h	2h	3h	5h	10h	20h
1.80V/cell	67.0	48.3	38.0	23.7	18.2	14.82	8.66	6.50	4.47	2.54	1.35
1.75V/cell	74.2	52.9	41.4	24.6	19.0	15.30	8.95	6.63	4.55	2.60	1.39
1.70V/cell	80.5	56.8	44.5	25.5	19.5	15.73	9.15	6.81	4.63	2.65	1.42
1.65V/cell	86.3	61.2	47.2	26.9	20.3	15.99	9.43	6.99	4.72	2.70	1.44
1.60V/cell	91.0	64.4	49.7	28.1	21.1	16.90	9.67	7.12	4.81	2.73	1.45

Constant Power Discharge (Watts per cell at 25°C/77°F)

F.V/Time	5min	10min	15min	30min	45min	1h	2h	3h	5h	10h	20h
1.80V/cell	125.2	85.3	72.0	44.5	34.6	28.86	16.67	12.61	8.84	5.20	2.68
1.75V/cell	134.2	91.7	75.9	46.4	35.8	29.48	17.13	12.89	8.92	5.24	2.70
1.70V/cell	143.2	96.2	79.6	47.8	37.2	29.93	17.52	13.13	9.07	5.28	2.75
1.65V/cell	149.6	101.3	83.2	50.2	38.4	31.03	17.89	13.43	9.22	5.31	2.78
1.60V/cell	155.8	104.8	86.1	52.0	39.3	31.88	18.25	13.62	9.31	5.33	2.81

Note: The above characteristics data are average values obtained within three charge/discharge cycles, not the minimum values.

Dimensions unitimm[inches]

T1 Terminal

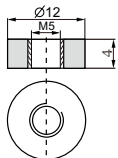

F3 Terminal

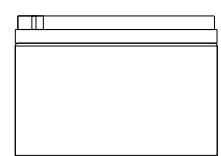
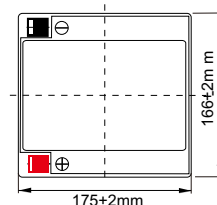
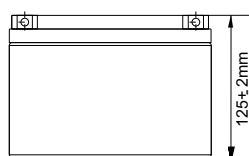
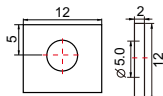

ML12-26_(12V26AH)

Storage characteristics

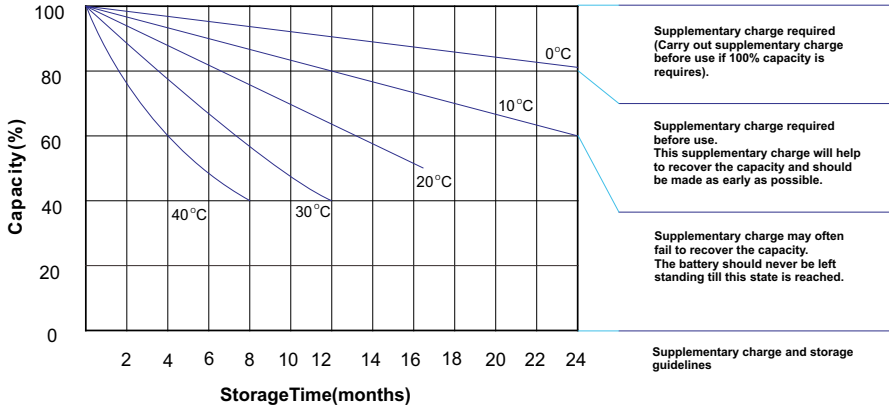

Effect of temperature on long term float life

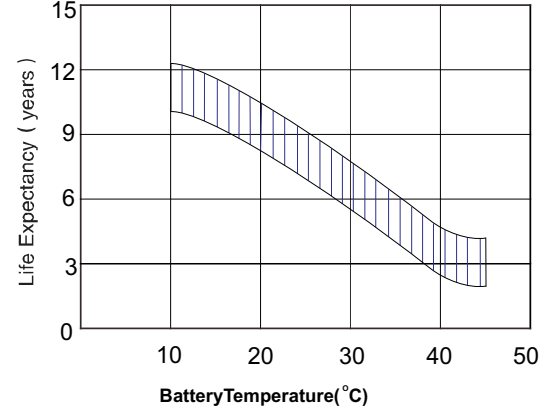

Charge characteristic Curve for standby use

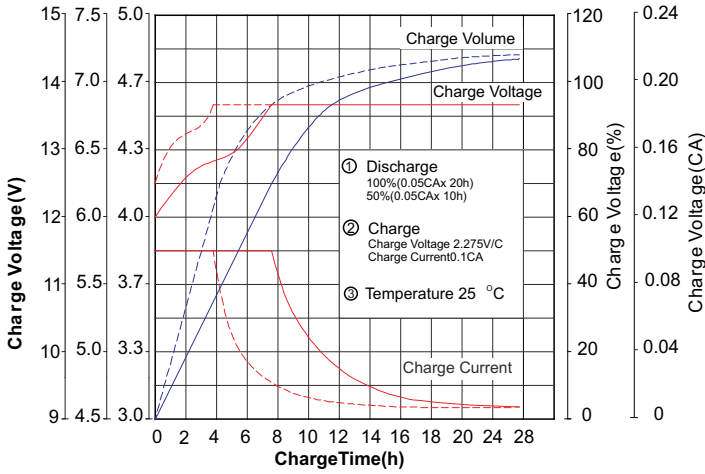

Cycle Life in Relation to Depth of Discharge

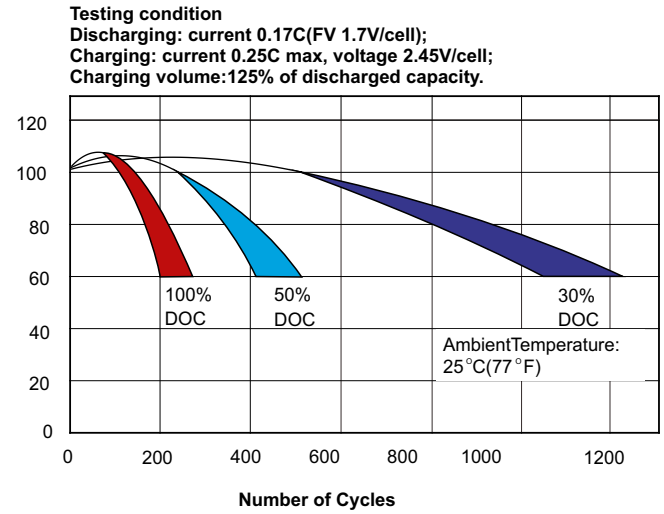

Discharge characteristic Curve

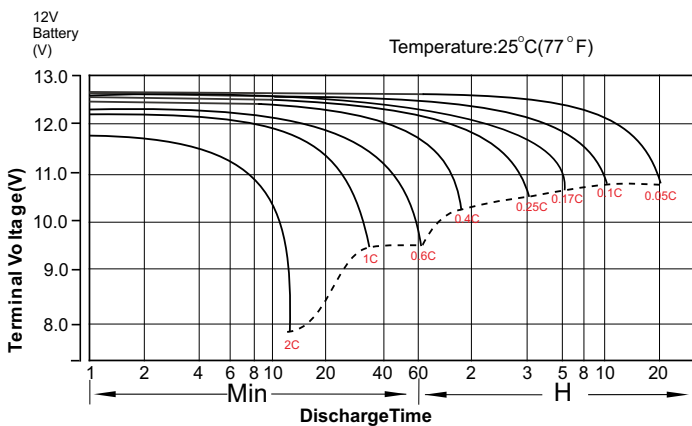

Temperature Effects in Relation to Battery Capacity

